

2016-061 Hamilton County  
May 9, 2016

RESOLUTION

WHEREAS, Cornerstone Construction of Chattanooga petitioned the Chattanooga-Hamilton County Regional Planning Commission to recommend to the County Mayor and Members of the County Commission the rezoning from A-1 Agricultural District to R-1 Single-Family Residential District, property located at 8908 Fuller Road.

An unplatted tract of land located at 8908 Fuller Road being the property described in Deed Book 10664, Page 635, ROHC. Tax Map 171C-E-014 as shown on the attached map.

AND WHEREAS, the Planning Commission held a public hearing on this petition on May 9, 2016,

AND WHEREAS, the Planning Commission heard and considered all statements regarding the petition,

AND WHEREAS, no one was present in opposition to the petition,

AND WHEREAS, the Planning Commission has studied the petition in relation to existing zoning and land use and potential patterns of development,

AND WHEREAS, the Planning Commission has determined that the proposal is consistent with surrounding uses.

NOW THEREFORE, BE IT RESOLVED that the Planning Commission, on May 9, 2016, recommended to the County Mayor and Members of the County Commission that this petition be approved.

Respectfully submitted,



John Bridger  
Secretary

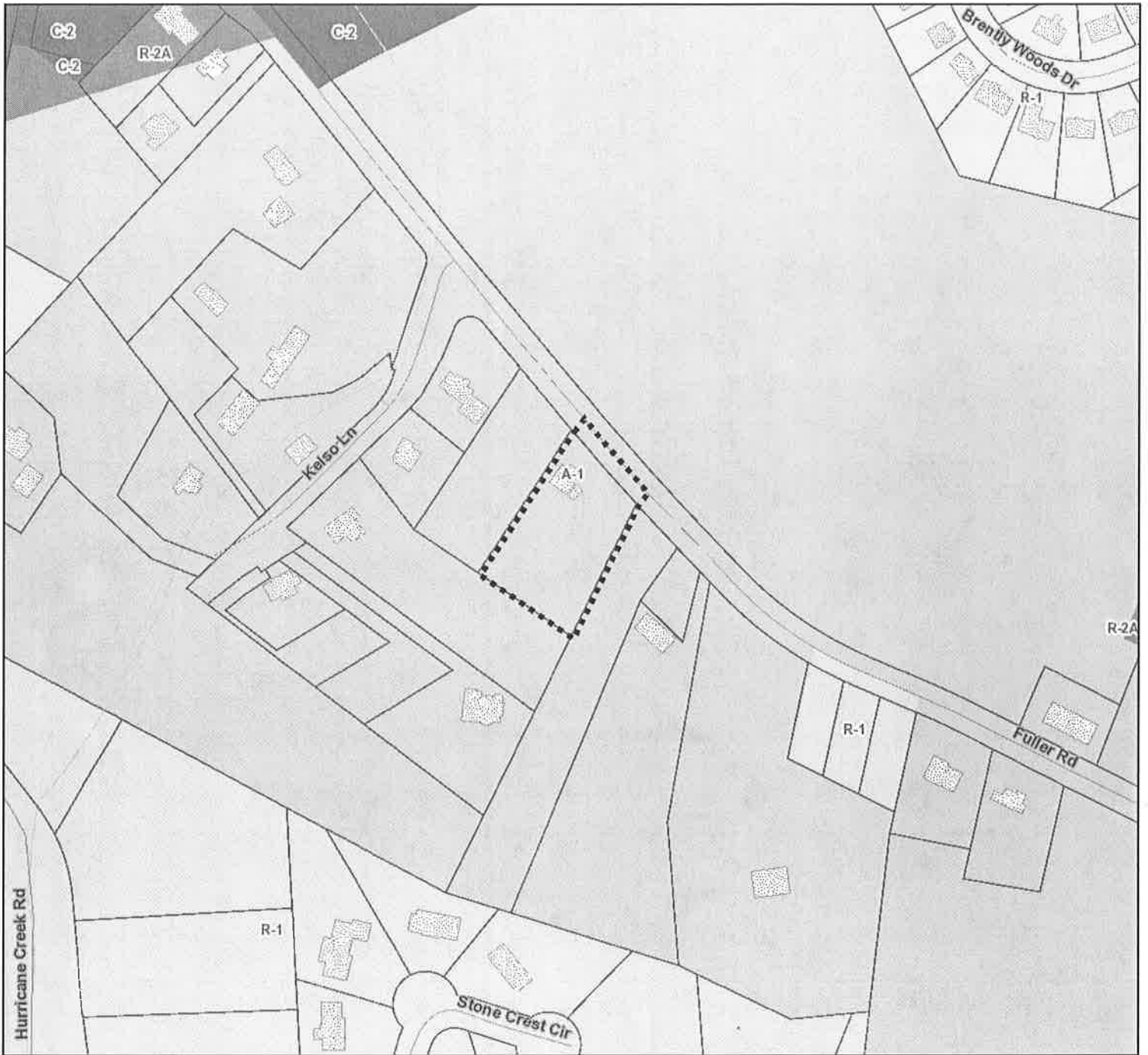

## 2016-061 Rezoning from A-1 to R-1

PLANNING COMMISSION RECOMMENDATION FOR CASE NO. 2016-061: Approve



215 ft



**Chattanooga Hamilton County Regional Planning Agency**

