

2016-031 City of Chattanooga  
March 14, 2016

## RESOLUTION

WHEREAS, Silverdale Baptist Church, Inc. petitioned the Chattanooga-Hamilton County Regional Planning Commission to recommend to the Members of the City Council of the City of Chattanooga the rezoning from R-1 Residential Zone to C-2 Convenience Commercial Zone, part of a property located at 2916 Silverdale Road.

Part of Lot 1, Silverdale Road Subdivision, Plat Book 100, Page 167, Deed Book 10402, Page 572, ROHC beginning at its northeast corner thence southwest some 160 feet, thence southeast some 41 feet, thence southeast some 86 feet, thence southwest some 50 feet, thence northwest some 106 feet, thence northwest some 83 feet, thence northeast some 185 feet, thence southeast some 50 feet to the point of beginning. Said dimensions are shown as Exhibit A on the site plan drawn by Map Engineers, dated 1/20/16 and made part of case file. Part of Tax Map 139G-D-001.01 as shown on the attached map.

AND WHEREAS, the Planning Commission held a public hearing on this petition on March 14, 2016,

AND WHEREAS, the Planning Commission heard and considered all statements regarding the petition,

AND WHEREAS, no one was present in opposition to the petition,

AND WHEREAS, the Planning Commission has studied the petition in relation to existing zoning and land use and potential patterns of development,

AND WHEREAS, the Planning Commission has determined that the proposal would be an extension of an existing zone.

NOW THEREFORE, BE IT RESOLVED that the Planning Commission, on March 14, 2016, recommended to the Members of the City Council of the City of Chattanooga that this petition be approved.

Respectfully submitted,



John Bridger  
Secretary

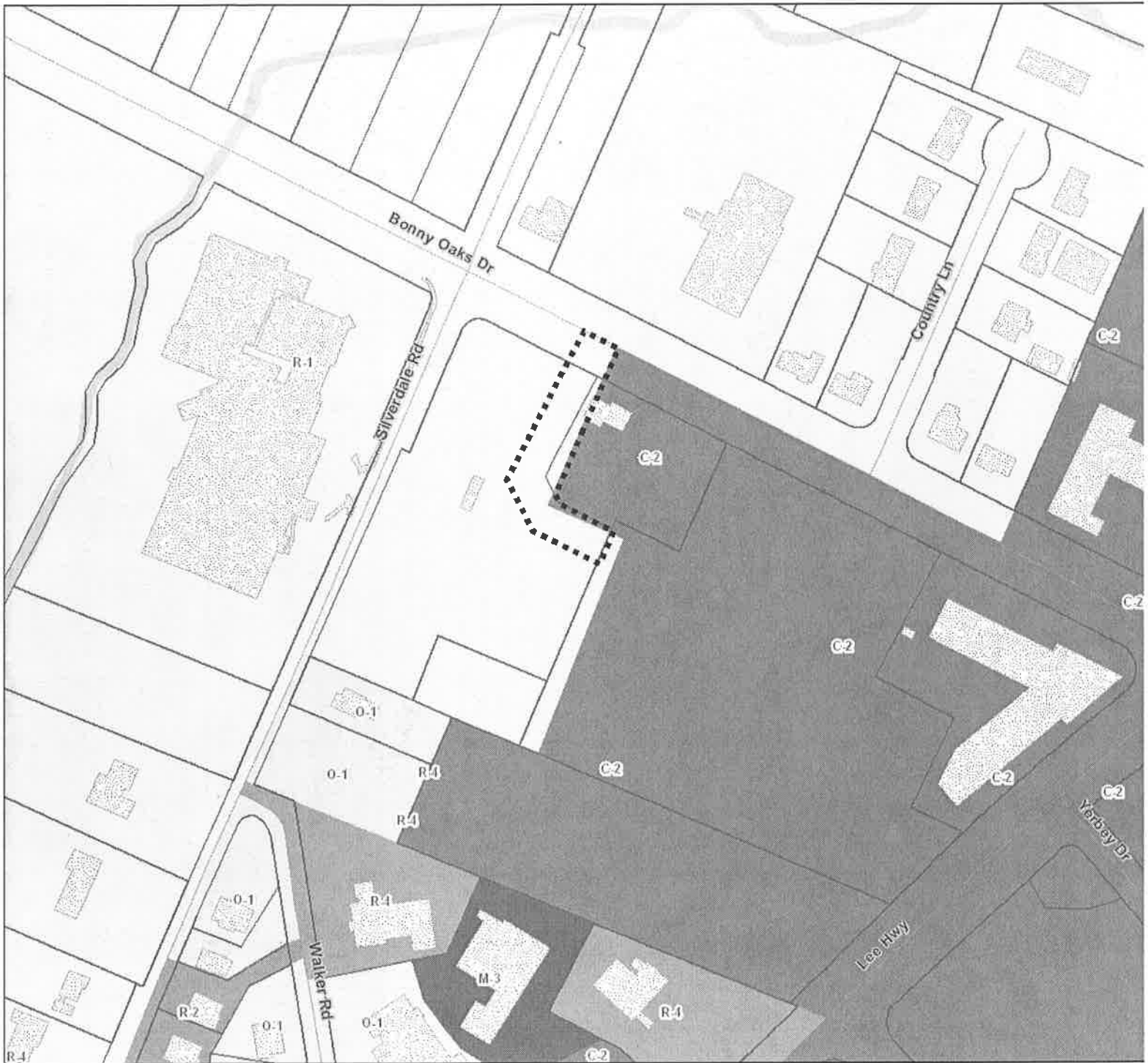

## 2016-031 Rezoning from R-1 to C-2

PLANNING COMMISSION RECOMMENDATION FOR CASE NO. MR-2016-031: Approve



200 ft



Chattanooga Hamilton County Regional Planning Agency

